

PUREX/TRITON SYSTEMS

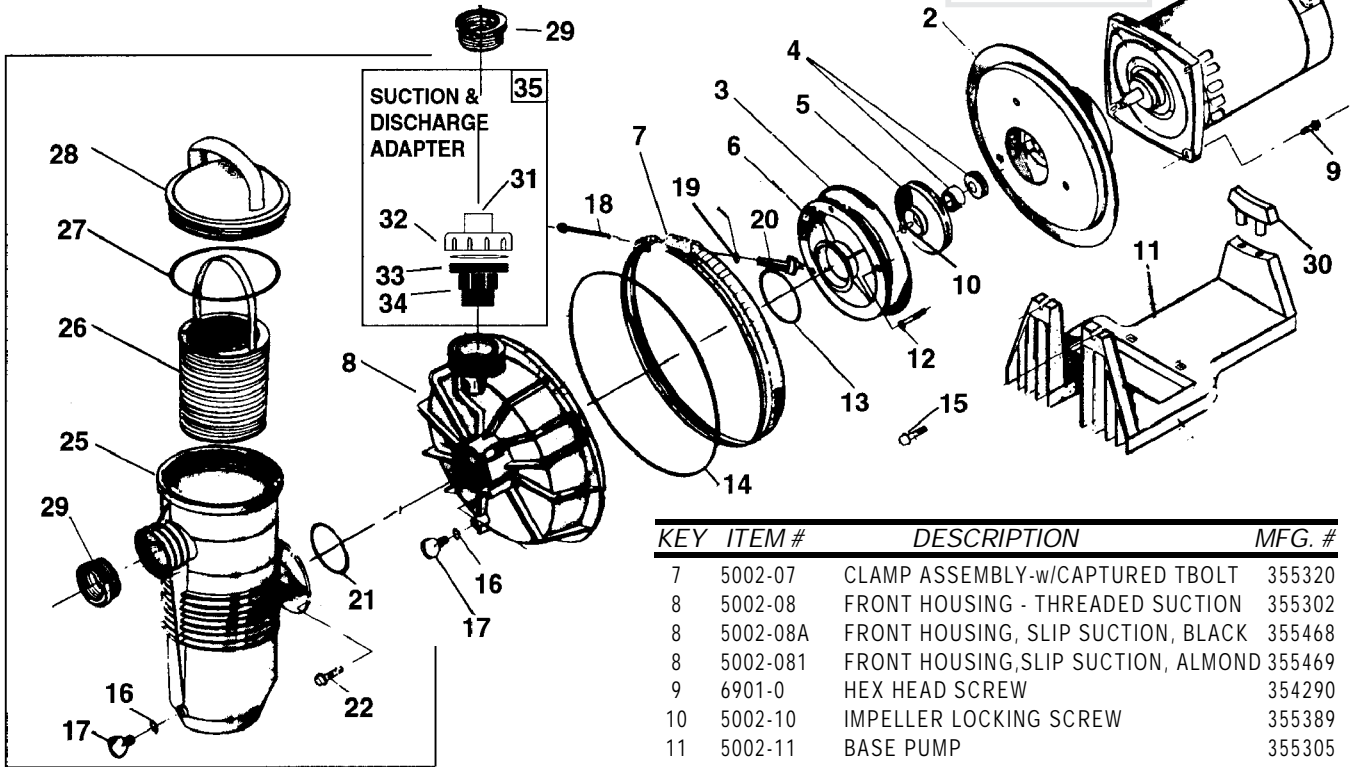
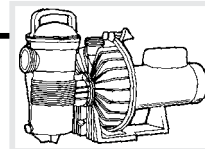

KEY ITEM # DESCRIPTION MFG. #

KEY ITEM #	DESCRIPTION	MFG. #
7	5002-07 CLAMP ASSEMBLY-w/CAPTURED TBOLT	355320
8	5002-08 FRONT HOUSING - THREADED SUCTION	355302
8	5002-08A FRONT HOUSING, SLIP SUCTION, BLACK	355468
8	5002-081 FRONT HOUSING,SLIP SUCTION, ALMOND	355469
9	6901-0 HEX HEAD SCREW	354290
10	5002-10 IMPELLER LOCKING SCREW	355389
11	5002-11 BASE PUMP	355305
12	5002-12 HEX HEAD SCREW FOR DIFFUSER	355334
13	5002-13 O-RING, DIFFUSER - HI-HEAD	355331
13	5002-13A GASKET, DIFFUSER (SQ. RING) MED HEAD	355030
14	5002-14 GASKET, FRONT HOUSING (SQ. RING)	355329
15	6913-0 SCREW, HEX HEAD	355335
16	3262-08 O-RING	192115
17	4600-4699 PLUG, DRAIN	154699
18	4600-2060 BOLT	152060
19	6981-0 WASHER	639822
20	5002-20 KNOB FOR REMOVEABLE BOLT	174882
20	5002-20A KNOB FOR CLAMP W/CAPT. T BOLT	175025
21	5002-21 O-RING, STRAINER	355330
22	6914-0 SCREW, HEX HEAD	354265
24	4600-4527 WRENCH, 8 1/2" CLOSURE	154527
25	5002-25 STRAINER POT	355300
25A	5002-25A STRAINER POT, 5 HP	355900
26	5002-26 BASKET, STRAINER	355318
26	5002-26A STRAINER BASKET-S.S., 3 HP	355441
26C	5002-26B STRAINER BASKET-S.S., 5 HP	355901
27	5002-27 O-RING, LID	355332
27A	4600-2509 GASKET, SQUARE RING	152509
28	5002-28 STRAINER LID	355301
28	9348-602 LID, GENERIC	25305-000-020
28	5002-28A STRAINER LID, F/BAQUACIL	354112
28C	5002-28B STRAINER LID , 5 HP	355902
29	7194-0 BUSHING, 2" X 1 1/2"	552377
30	5002-30 SUPPORT, MOTOR	355385
31	5002-31 ADAPTER (2" SLIP)	274406
32	4600-4407 NUT, UNION	274407
33	4600-4494 O-RING, UNION	274494
34	4600-5304 ADAPTER (2" MPT)	355304
35	5008-0 QUICK DISCONNECT UNIONS (SET OF 2) (2" MPT x 2" SKT/1-1/2" SLIP)	355309
36	5002-60 POT ASSY WITH PLASTIC BASKET (INCLUDES KEYS 25 - 28, 16, & 17)	359507

EXTRA LARGE TRAP (5HP)

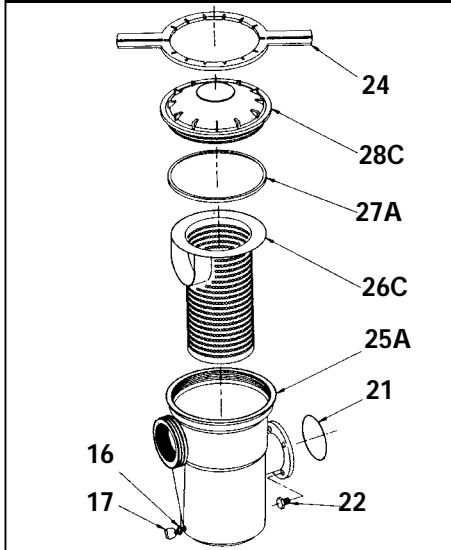

KEY ITEM # DESCRIPTION MFG. #

KEY ITEM #	DESCRIPTION	MFG. #
1	5237-0 MOTOR, 5HP, 3 PHASE, 230/460V	355704
1	5237A MOTOR, 5HP, 1 PHASE, 230V	355705
1	VARIOUS MOTOR - SQUARE FLANGE FRONT OF SECT G	
2	5002-02 SEAL PLATE (ALL EXCEPT 5 HP) BLACK	355303
2	5002-021 SEAL PLATE - ALMOND	355528
2	5002-02A SEAL PLATE, 5 HP ONLY	355497
3	MOUNTING PLATE (SEE CHART ON 2 PAGES)	
4	5250-104 SEAL, PUMP	354545
5	IMPELLER (ON NEXT TWO PAGES)	
6	DIFFUSER (ON NEXT TWO PAGES)	

**THE 5HP MOTORS ARE UNIQUE TO THIS PUMP
OTHER HP PUMPS USE STANDARD MOTORS.**



FOR HIGH HEAD PUMPS, SEE NEXT PAGE



PAC FAB MODEL #.	PAC FAB PUMP # (SEE NOTE 1)	HP	RATING (SEE NOTE 2)	DIFFUSER ITEM # (MFG #)	IMPELLER ITEM # (MFG #)	MOUNTING PLATE ITEM # (MFG #)
CFII-N1-1/2F	34-2732 34-2232 34-4732	1/2	FULL	5002-06AA (35-5029)	5002-05AA (35-5043)	5002-03B (35-5028)
CFII-N1-3/4F CFII-N1-3/4FE*	34-2733 34-2233 34-4733 34-4743* 34-2243*	3/4	FULL	5002-06AA (35-5029)	5002-05BA (35-5067)	5002-03B (35-5028)
CFII-N1-3/4A	34-3732 34-3232 34-7732	3/4	UP	5002-06AA (35-5029)	5002-05AA (35-5043)	5002-03B (35-5028)
CFII-N1-1F CFII-N1-1FE*	34-2734 34-2234 34-4734 34-4735* 34-2235*	1	FULL	5002-06BA (35-5077)	5002-05CA (35-5074)	5002-03C (35-5078)
CFII-N1-1A CFII-N1-1AE*	34-3733 34-3233 34-7733 34-7735** 34-3235*	1	UP	5002-06AA (35-5029)	5002-05BA (35-5067)	5002-03B (35-5028)
CFII-N1-1 1/2F CFII-N1-1 1/2FE*	34-2736 34-2236* 34-4731 34-4736* 34-2231	1 1/2	FULL	5002-06BA (35-5077)	5002-05DA (35-5086)	5002-03C (35-5078)
CFII-N1-1 1/2A CFII-N1-1 1/2AE*	34-3734 34-3234 34-7734 34-7737*	1 1/2	UP	5002-06BA (35-5077)	5002-05CA (35-5074)	5002-03C (35-5078)
CFII-N1-2F CFII-N1-2FE*	34-3237* 34-2738 34-2238*	2	FULL	5002-06CA (35-5094)	5002-05EA (35-5093)	5002-03D (35-5095)
CFII-N1-2A CF11-N1-2AE*	34-3738 34-3238* 34-7740 34-7738* 34-3240	2	UP	5002-06BA (35-5077)	5002-05DA (35-5086)	5002-03C (35-5078)
CFII-N1-2 1/2AE*	34-3739* 34-3235*	2 1/2	UP	5002-06CA (35-5094)	5002-05EA (35-5093)	5002-03D (35-5095)
CFII-N1-5FE	34-5210	5	FULL	5002-06DA (35-5069)	5002-05FA (35-5068)	5002-03E (35-5495)

* ENERGY EFFICIENT

** 2 SPEED

NOTE 1: VARIES W/BRAND OF MOTOR ON PUMP

NOTE 2: SEE PAGE G-12 FOR UPATED VS FULL RATED EXPLANATION



HIGH HEAD IMPELLER/DIFFUSER SELECTION CHART

PUREX/TRITON SYSTEMS



PAC FAB MODEL NO.	PAC FAB PUMP (See Note 1)	H.P.	RATING (See Note 2)	DIFFUSER OUR ITEM NO. (PAC FAB NO.)	IMPELLER OUR ITEM NO. (PAC FAB NO.)	MOUNTING PLATE OUR ITEM NO. (PAC FAB NO.)
CHII-N1-1/2F	34-5702 34-5202 34-5562	1/2	FULL	5002-06 (35-5148)	5002-05 (35-5147)	5002-03A (35-5384)
CHII-N1-3/4F CHII-N1-3/4FE*	34-5703 34-5203 34-5713* 34-5223** 34-5723** 34-5563 34-5573* 34-5213*	3/4	FULL	5002-06A (35-5188)	5002-05A (35-5187)	5002-03 (35-5317)
CHII-N1-3/4A	34-6703 34-6203 34-6563	3/4	UP	5002-06 (35-5148)	5002-05 (35-5147)	5002-03A (35-5384)
CHII-N1-1F CHII-N1-1FE*	34-5704 34-5204 34-5705* 34-5205* 34-5724** 34-5224** 34-5564 34-5565*	1	FULL	5002-06A (35-5188)	5002-05B (35-5369)	5002-03 (35-5317)
CHII-N1-1A CHII-N1-1AE*	34-6704 34-6204 34-6705* 34-6724** 34-6224** 34-6564 34-6565* 34-6205*	1	UP	5002-06A (35-5188)	5002-05A (35-5187)	5002-03 (35-5317)
CHII-N1-1 1/2F CHII-N1-1 1/2FE*	34-5706* 34-5206* 34-5726** 34-5226** 34-5566* 34-5201	1 1/2	FULL	5002-06B (35-5270)	5002-05C (35-5315)	5002-03 (35-5317)
CHII-N1 1 1/2A CHII-N1-1 1/2AE	34-6706 34-6206 34-6707* 34-6207* 34-6726** 34-6226** 34-6566 34-6567**	1 1/2	UP	5002-06A (35-5188)	5002-05B (35-5369)	5002-03 (35-5317)
CHII-N1-2FE*	34-5708* 34-5208* 34-5728* 34-5228**	2	FULL	X 5002-06C (35-5316)	X REPLACE (35-5431)	5002-03 (35-5317)
CHII-N1-2A CHII-N1-2AE*	34-6708 34-6208* 34-6728** 34-6228** 34-6568* 34-6201	2	UP	5002-06B (35-5270)	5002-05C (35-5315)	5002-03 (35-5317)
CHII-N1-2 1/2AE*	34-6709* 34-6209* 34-6729** 34-6229**	2 1/2	UP	X 5002-06C (35-5316)	X REPLACE (35-5431)	5002-03 (35-5317)
CHII-N1-3FE*	34-5709 34-5799* 34-5209* 34-5299*	3	FULL	5002-06D (35-5545)	5002-05E (35-5544)	5002-03 (35-5317)

X NO LONGER AVAILABLE - REPLACE WITH 5002-05F (35-5604) AND 5002-06D (35-5545) * ENERGY EFFICIENT ** 2 SPEED
NOTE 1: VARIES W/ BRAND OF MOTOR NOTE 2: SEE PAGE G-12 FOR UP-RATED VS. FULL-RATED EXPLANATION